

MEDIUM FLAT PANEL WALL MOUNTS – FIXED

CUSTOM OR UNIVERSAL

NEW

FUSION
FIXED AND TILT WALL MOUNTS

MSR™ FIXED WALL MOUNT

Mounting flexibility and ultra low-profile design that is ideal for digital display or retail signage.



FAQ

1. What screen size is the MSR designed for?
A The MSR is designed for 26"–40" medium flat panels up to 100 lbs.
2. Is the MSR available as a universal solution?
A Yes. Simply order the MSR-V and get a VESA universal solution that accommodates 100 x 100 mm, 200 x 100 mm, 200 x 200 mm, 400 x 200 mm, 300 x 100 mm and 300 x 200 mm patterns. See ordering steps below to order a custom solution.

HOW TO ORDER

1. Determine which style mount will best suit your needs.
2. For custom model number, look up your display in the cross-reference chart or on the website. Order MSR-xxxx, model number includes interface bracket.
3. For universal VESA® model number, order MSR-V.
4. Order MSR-210 for VESA patterns 100 x 100 mm, 200 x 100 mm, 200 x 200 mm,
5. Fax or e-mail your order to Customer Service at P 020 8908 3111 F 020 8908 3110 ,or sales@hypexuk.com

- **Q-Latch™ Mounting System**
 - Offers quick connect/disconnect
 - Secures display with a latching flag
 - Includes integrated security with the addition of a padlock
 - Mounts in portrait or landscape positions



- **Rapid Level™ System**
Provides hands-free leveling of mount on wall.

- **Ultra Low-Profile Design**
Ensures the mount stays hidden behind the screen.

- **Cable Management**
Expanded wall plate opening provides cable access and reduces risk of outlet interference.

- **Solid Steel Construction**
Designed with heavy gauge steel, pre-drilled studs and lock nuts for ultimate strength.

- **Integrated Lateral Shift**
For easy positioning of screen, up to 1-1/2" (32 mm).

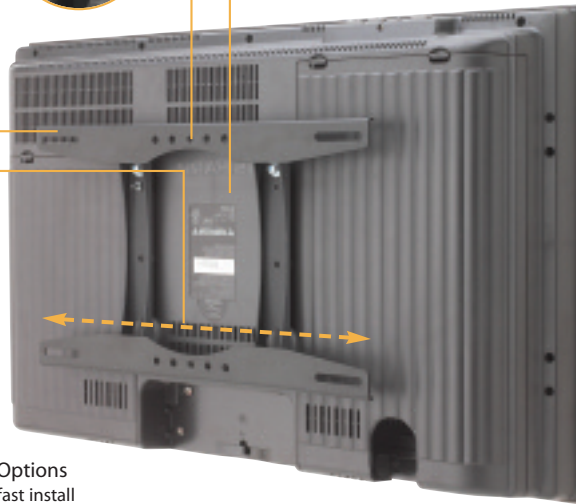

- **Multiple Ordering Options**
 - Custom interface for fast install
 - Universal for stocking; order MSR-V
 - Wall mount without interface for pre-installation

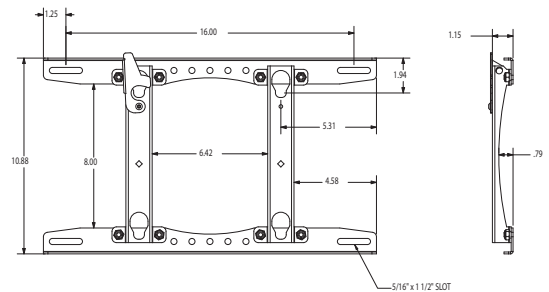

SPECIFICATIONS

Depth From Wall*	1-1/4" (32 mm)
Dimensions WxHxD	18-1/2" x 10-7/8" x 1-1/4" (470 x 276 x 32 mm)
Lateral Shift	1-1/2" (38 mm) left/right of 16" (40 cm) Centers 2" (51 mm) left/right of Single Stud
Color	Black
Weight Capacity	100 lbs (45.4 kg)

* Depth does not include interface bracket.

RECOMMENDED ACCESSORIES

PAC-115 Steel Stud/Drywall Anchor Kit	67
PAC-125 Lateral Shift Accessory	67